

WIS Series
 Wound Chip Inductor
 Size 1812

CHARACTERISTICS

- Small size and higher inductance available
- Small tolerance available
-

APPLICATION

- Filter
-

Dimensions: [mm]

Land Pattern: [mm]

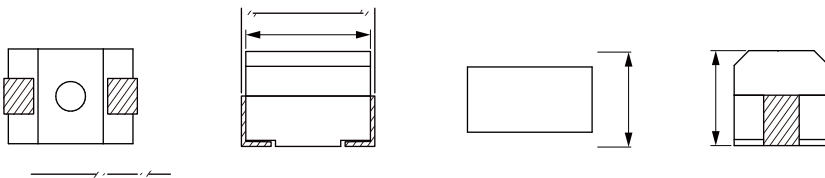

Electrical Properties:

Part No	Inductance	Tolerance	Q Min.	Test Freq	SRF Min.	DCR Max.	Temperature Rise Current Max.
	18				16		
	22				14		
	27				13		
	33				12		
	39				11		
	47						
	68						
	82						
					8		
					7		
					6		
					0		
						12	92
						14	
						18	
						26	62
					3		
					3		

°C °C

°C

Typical Electrical Characteristics:

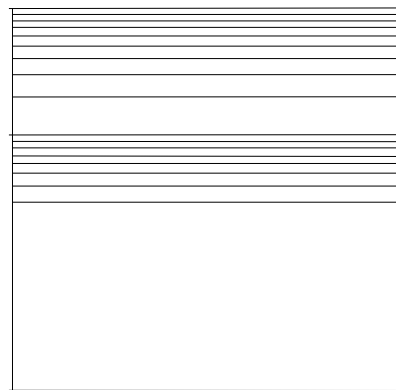
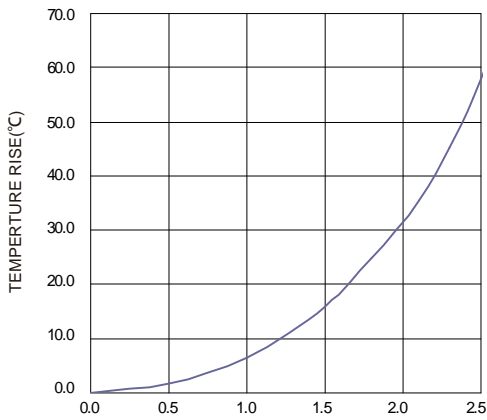

TEMPERATURE RISE (°C)

TEMPERATURE RISE (°C)

TEMPERATURE RISE (°C)

IMPEDANCE []

IMPEDANCE []

IMPEDANCE []

FREQUENCY [MHz]

FREQUENCY [MHz]

FREQUENCY [MHz]